

WILDLIFE REFUGES AND CLOSED AREAS



Version 3: September 1990  
Voigt Intertribal Task Force

Biological Services Division/Wildlife Section  
Great Lakes Indian Fish and Wildlife Commission  
P. O. Box 9 Odanah, WI 54861  
(715) 682-6619

Table of Contents

Table of Contents . . . . . pg. 1  
Introduction . . . . . pg. 2

Wildlife Refuges

WR 1: No hunting or trapping  
    Crex Meadows . . . . . pg. 3  
    Wissota . . . . . pg. 3

WR 2: No waterfowl hunting; no entry 10/1 - 11/30.  
    Brule River . . . . . pg. 4  
    Powell Marsh . . . . . pg. 4

WR 3: No waterfowl hunting; no entry 9/1 - 12/31.  
    Crex Meadows . . . . . pg. 5

WR 4: No waterfowl hunting; no entry 10/1 - 11/15.  
    Beans Eddy . . . . . pg. 5  
    Townline Reservoir . . . . . pg. 6  
    Honey Island Flowage . . . . . pg. 6  
    McMillan Marsh . . . . . pg. 7  
    Mead . . . . . pg. 7  
    Steinke Pond . . . . . pg. 8  
    Mead . . . . . pg. 8

WR 5: No entry 4/1 - 9/15.  
    Fish Lake . . . . . pg. 9  
    Mead . . . . . pg. 9

Closed Areas

CA 1: Waterfowl closed area, deer hunting permitted.  
    Fish Lake . . . . . pg. 10  
    Rice Lake . . . . . pg. 10

CA 2: Sharp-tailed grouse closed area.  
    Moquah Barrons . . . . . pg. 11  
    Crex Meadows . . . . . pg. 11  
    Namekagon Barrons . . . . . pg. 12  
    Douglas County Wildlife Area . . . . . pg. 12

CA 3: Waterfowl closed area, trapping and deer hunting permitted.  
    Oakridge Lake . . . . . pg. 13

CA 4: Waterfowl closed area except deer and special  
    goose hunting permitted  
    Douglas County Hospital Fields . . . . . pg. 13

CA 5: Waterfowl closed area.  
    Pershing . . . . . pg. 14

CA 6: Fisher/Marten closed area.  
    Clam Lake . . . . . pg. 14  
    Pine River . . . . . pg. 15

## INTRODUCTION

The intent of this publication is to provide a readily accessible means of identifying and locating wildlife refuges and closed areas which are incorporated in Tribal off-reservation hunting ordinances. The wildlife refuges and closed areas identified in this document are public lands located in the Wisconsin portion of the Ceded Territory which are closed to hunting and/or trapping at times.

These refuges and closed areas are established to protect certain species of wildlife. Most of them are designed to protect waterfowl during nesting and migrations, for example, many of the closed areas are only closed during the waterfowl hunting season. Others, however, protect such species as fisher, martens and sharp-tailed grouse.

All refuges and closed areas contained in this booklet are also closed to state hunters and trappers. They all are required to be clearly marked and you should not accidentally wander into them.

This is the third version of this refuge and closed area publication and contains all areas in the Wisconsin Ceded Territory which are designated closed areas or refuges pursuant to the mandates of the Voigt case.

These closed areas apply to members of 1837 and 1842 signatory tribes which have enacted a tribal ordinance in compliance with the Voigt case decisions and stipulations.

The contents of this publication may be modified from time to time. You may wish to check with the Biological Services Division or Policy Analyst of the Great Lakes Indian Fish and Wildlife Commission to see that the date given on the title pages is the date of the booklet's most recent update.

All of the maps used in this document, except the Pine River Closed area, were taken from the Wisconsin Administrative Code, Department of Natural Resources, Madison, WI 53707. The Pine River closed area map was taken from the US Forest Service, Nicolet National Forest.

WILDLIFE REFUGES

WR 1: No member may hunt or trap in these areas or have in possession or under control any gun or rifle unless the same are unloaded and enclosed within a carrying case, or any bow unless it is unstrung or enclosed in a carrying case.

WR 1(a): Burnett County. Crex Meadows, Township 39 north, range 18 West, town of West Marshland.

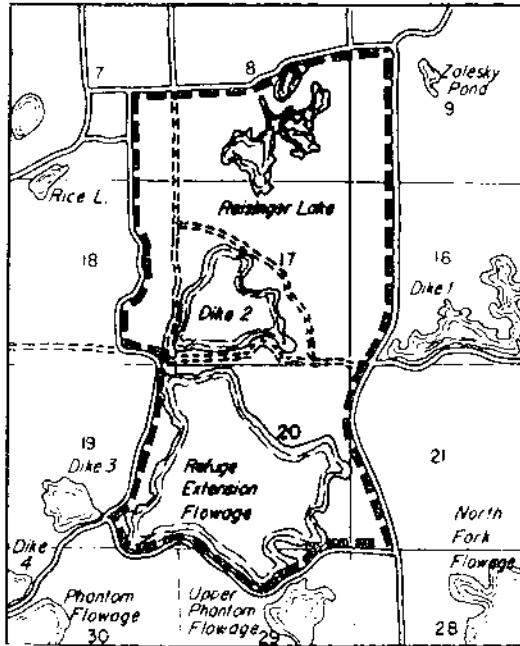

WR 1(b): Chippewa County. Wissota. Township 29 north, range 7 west, town of Anson.

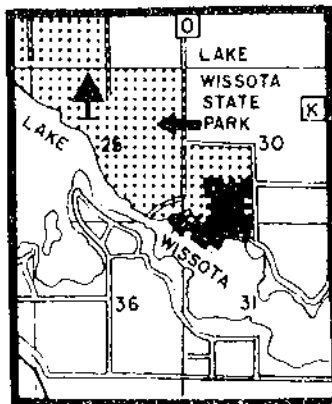

WR 2: No member may hunt waterfowl at any time, or enter these areas for any reason from September 1 through December 31, except to hunt deer during the middle season and except for the retrieval of legally killed or crippled game in posted retrieval zones.

WR 2(a): Douglas County. Brule River. Township 49 north, range 10 west, town of Cloverland.

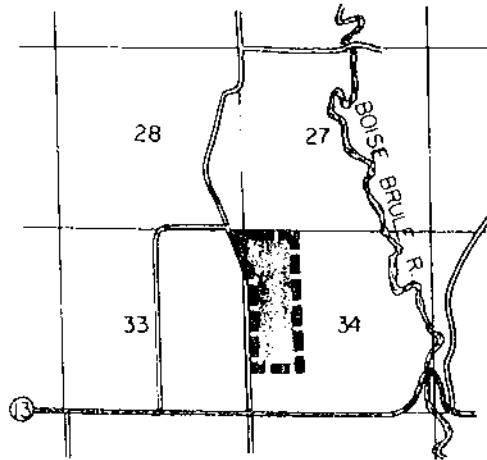

WR 2(b): Vilas County. Powell Marsh. Township 42 north, range 5 east, town of Manitowish Waters.

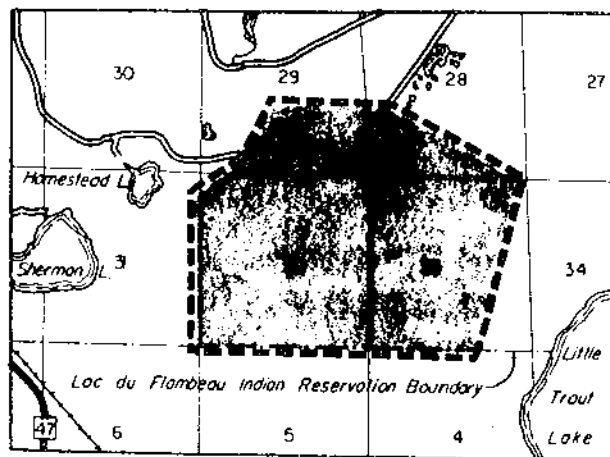

WR 3: No member may hunt waterfowl at any time, or enter these areas for any reason from September 1 through December 31, except for the retrieval of legally killed or crippled game in posted retrieval zones.

WR 3(a): Burnett County. Crex Meadows. Township 39 north, range 18 west, town of West Marshland.

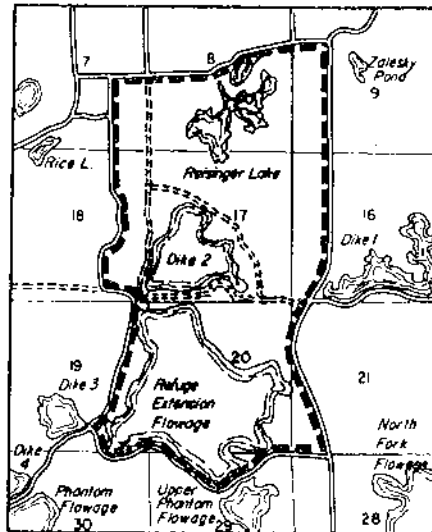

WR 4: No member may hunt waterfowl at any time, or enter such areas for any reason from October 1 through November 15 except for the retrieval of legally killed or crippled game in posted retrieval zones.

WR 4(a)(1): Marathon County. Beans Eddy. Township 26 north, range 6 east, town of Bergen.

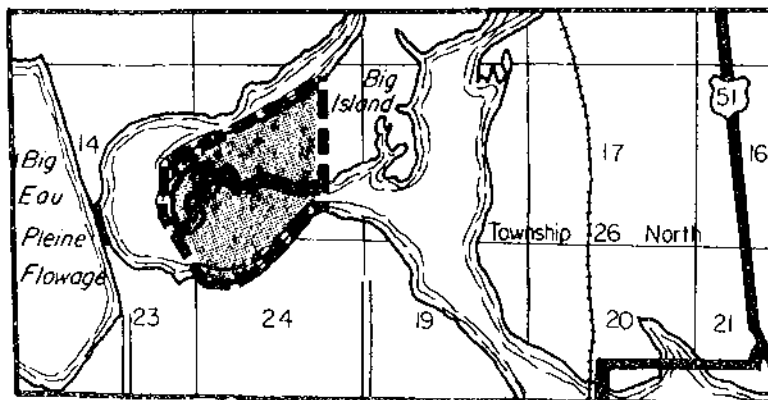

WR 4(a)(2): Marathon County. Townline Reservoir.  
Township 26 north, range 6 east, town of  
Bergen.

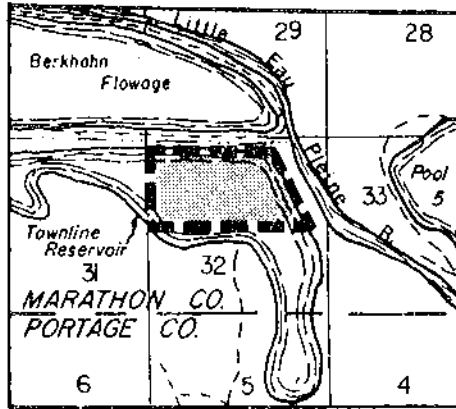

WR 4(a)(3): Marathon County. Honey Island Flowage.  
Township 26 north, range 5 east, town of  
Green Valley.

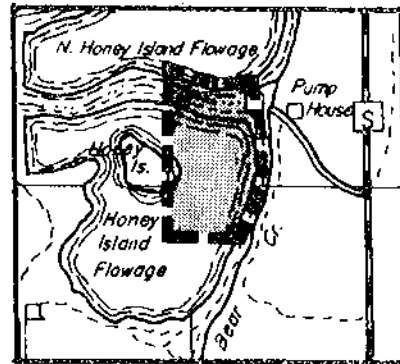

WR 4(a)(4): Marathon County. McMillan Marsh. Township 26 north, range 2 east, town of Spencer and township 26 north, range 3 east town of McMillan.

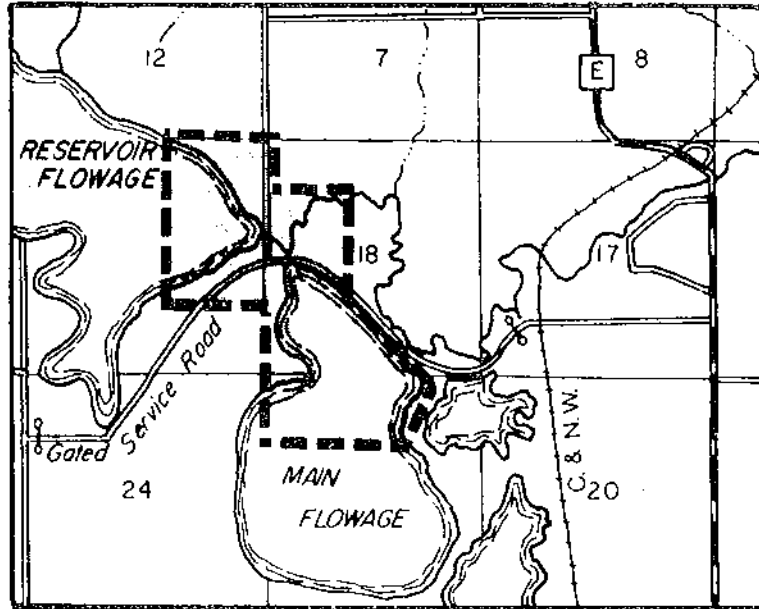

WR 4(a)(5): Marathon County. Mead. Township 26 north, range 5 east, town of Green Valley.

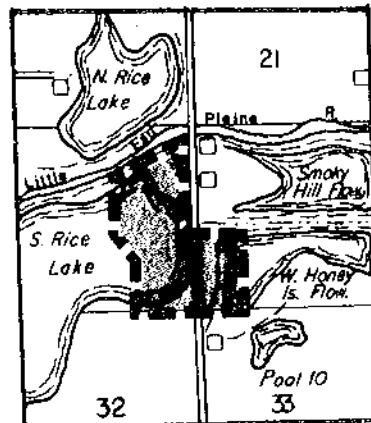



WR 4(a)(6): Marathon County. Steinke Pond. Township 30 north, range 10 east, town of Harrison.

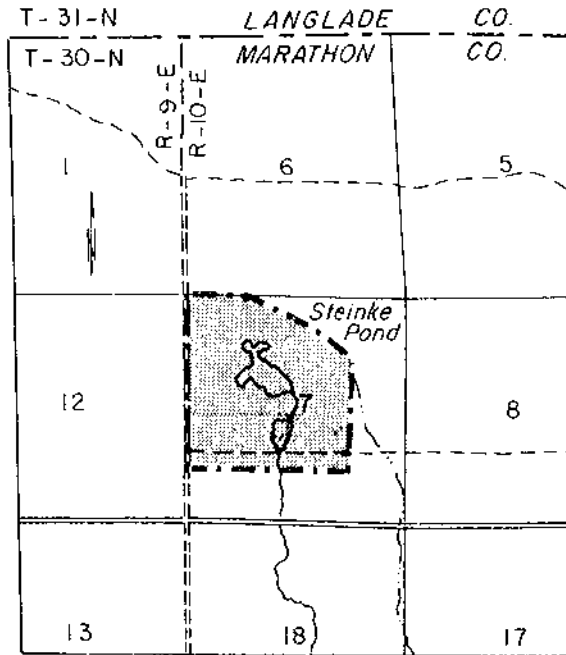

WR 4(b): Marathon and Wood County. Mead. Township 25 north, range 5 east, town of Milladore and township 26 north, range 5 east, town of Green Valley.

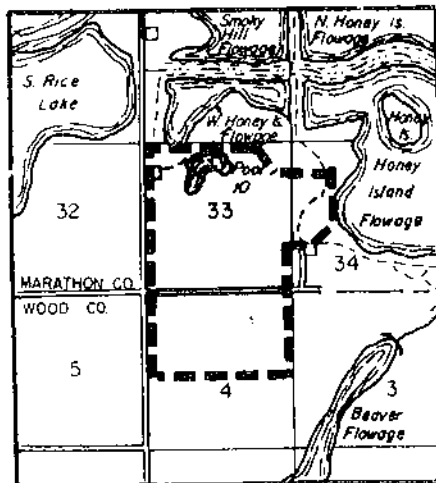

WR 5: No member may enter upon these areas for any reason from April 1 through September 15.

WR 5(a): Burnett County. Fish Lake. Township 37 north, range 19 west, town of Anderson.

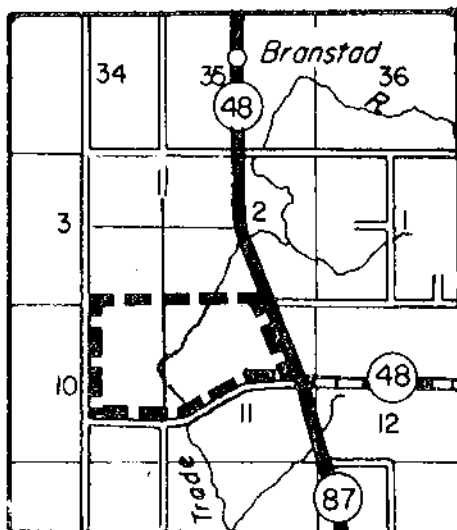

WR 5(b): Marathon County. Mead. Township 26 north, range 6 east, town of Bergen.

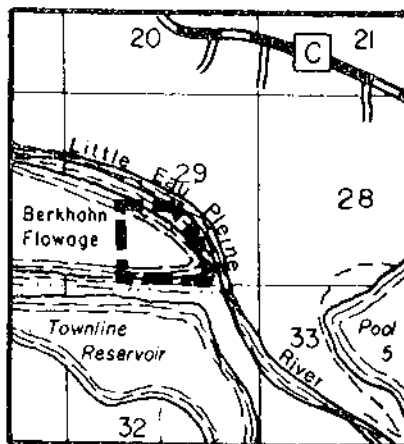

Closed Areas

CA 1: Waterfowl closed areas; deer hunting permitted. No member may hunt or trap any species of wild animal except to hunt deer during the middle season during the open season for waterfowl.

CA 1(a): Burnett County. Fish Lake Wildlife Area. Township 37 north. Range 19 west, town of Anderson.

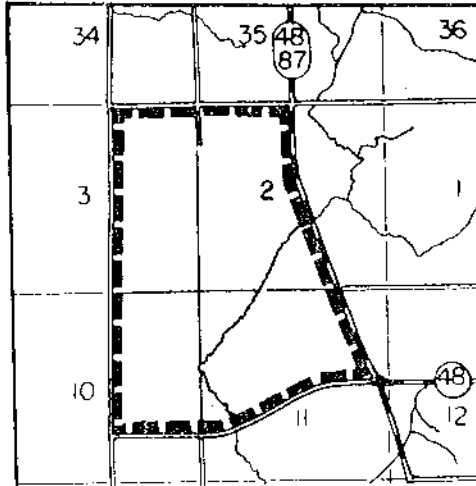

CA 1(b): Oneida County. Rice Lake. Township 38 north, range 10 east, and township 39 north, range 10 east, town of Three Lakes.

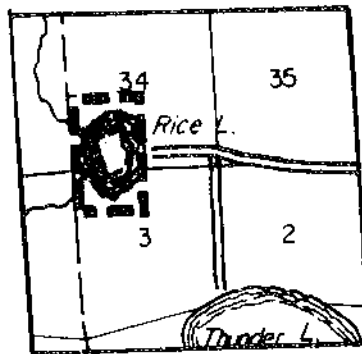

CA 2: Sharp-tailed grouse closed area. No member may hunt sharp-tailed grouse at any time.

CA 2(a): Bayfield County. Moquah Barrons. Township 48 north, range 7 west, towns of Barksdale and Washburn and township 48 north, range 8 west, town of Tripp.

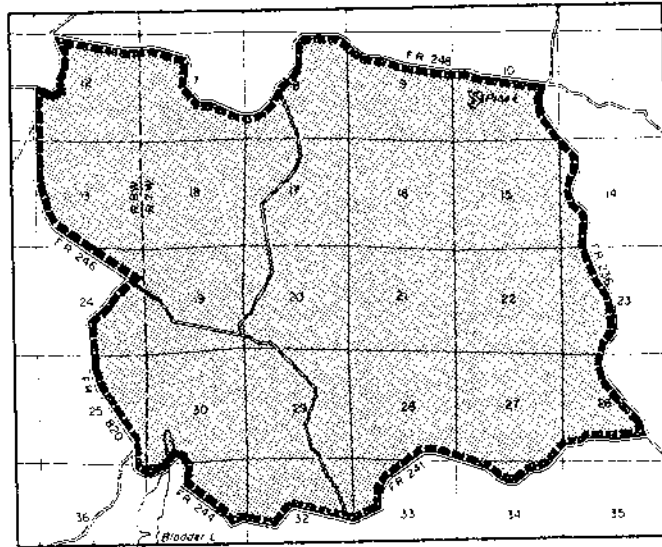

CA 2(b)(1): Burnett County. Crex Meadows. Township 39 north, range 18 - 19 west, town of West Marshland.

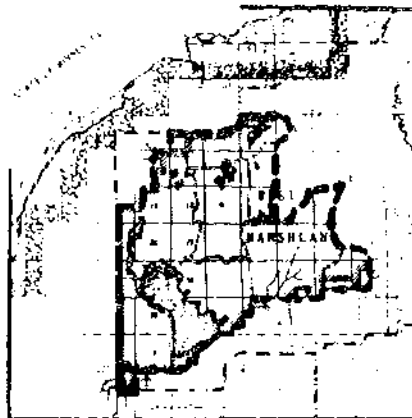

CA 2(b)(2): Burnett County. Namekagon Barrons. Township 42 north, range 14 west, town of Blaine East.

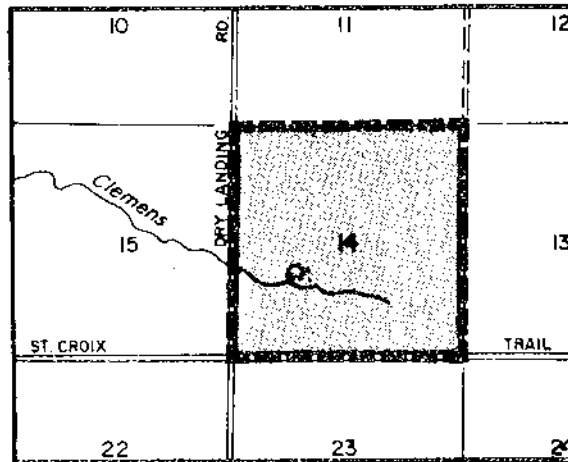

CA 2(c): Douglas County. Douglas County Wildlife Area. Township 44 north, range 12 west, towns of Gordon and Solon Springs.

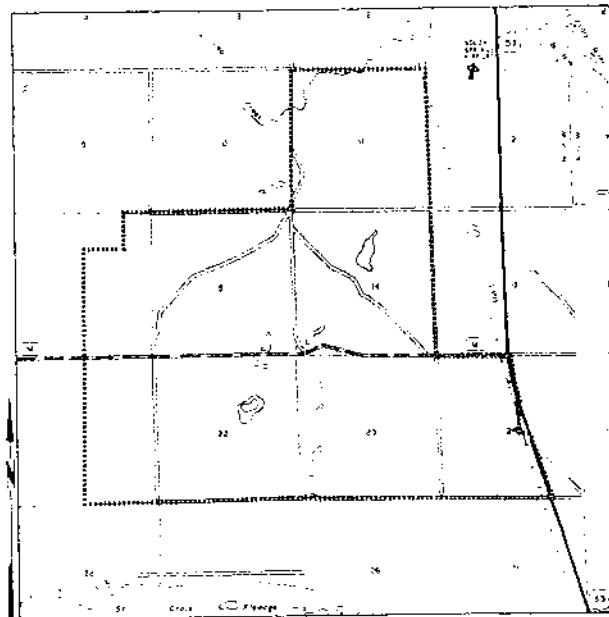

CA 3: Waterfowl closed area; trapping and deer hunting permitted. No member may hunt any species of wild animal, except deer hunting during the middle season, during the open season for waterfowl.

CA 3(a): St. Croix County. Oakridge Lake. Township 3 north, range 17 west, town of Stanton.

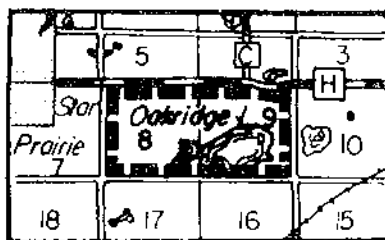

CA 4: Waterfowl closed area except deer and special goose hunting. No member may hunt or trap any species of wild animal except Canada geese during the tribal goose season and deer during the middle deer season, during the open season on waterfowl.

CA 4(a): Douglas County. Douglas County Hospital Fields. Township 48 north, range 13 west, town of Packland.

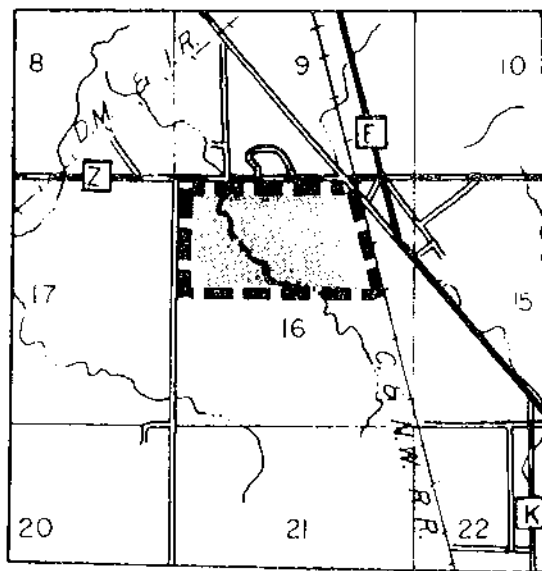

CA 5: Waterfowl closed area. No member may hunt or trap any species of wild animals during the open season for waterfowl.

CA 5(a): Taylor County. Pershing. Township 33 north, range 4 west, town of McKinley.

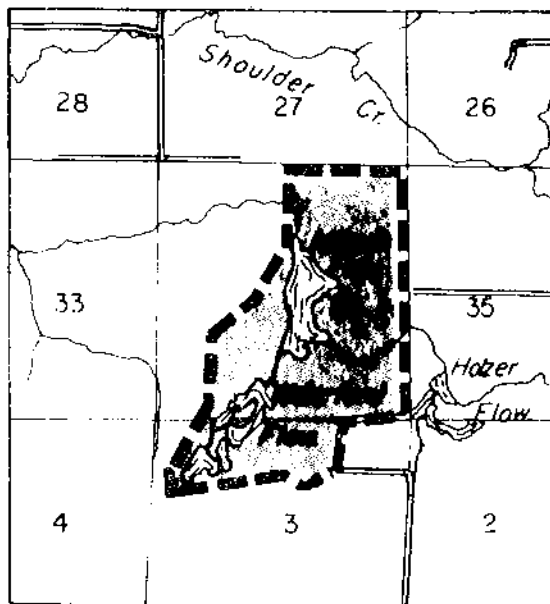

CA 6: Fisher/Marten closed area. No member may trap any species of wild animal at any time except for beaver, otters, muskrat and mink during their open season with sets placed so that a trapped animal may reach the water.

CA 6(a): Ashland, Bayfield and Sawyer Counties. Clam Lake.

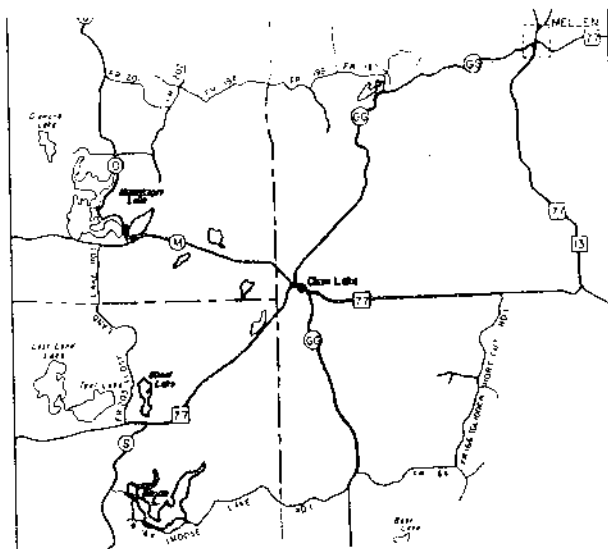

CA 6(b): Forest, Oneida and Vilas Counties. Pine River.

